

STARPOINT eye nut VRM-M6

Artikel-Nr: 7900786



- Lifting points pivots 360° for an easy adjustment in load direction.
- Clear marking of the minimum WLL for all loading directions.
- The WLL statement corresponds to the minimum WLL in all loading directions. Higher WLL possible when location and installation is optimised (compare WLL chart).
- Available as: - Standard Metric Thread M6-M30 (DIN EN 13)
- Special coating on request.
- Component according to the test criterias of BG/DGUV "GS-OA-15-04".
- Quick and easy installation with just one bolt connection.
- Hand tightening with appropriate wrench is sufficient for a singular lift.

Other important RUD specific information and specialities to our RUD lifting points can be found in the specific user instruction.

STARPOINT eye nut VRM-M6

Artikel-Nr: 7900786

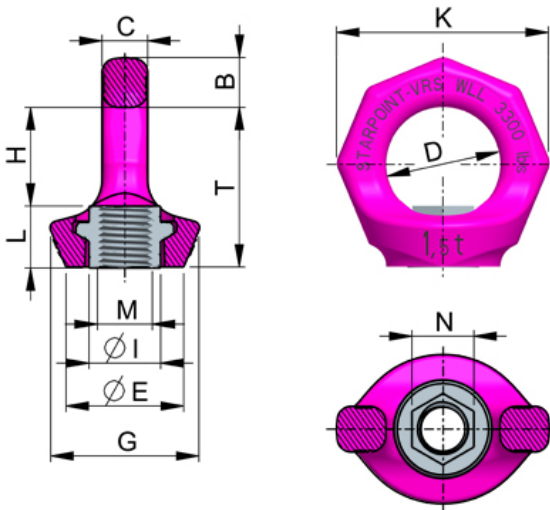

weight	0.06 kg	0.13 lbs
Nominal WLL	100 kg	220 lbs
T	28 mm	1-1/8"
B	9 mm	11/32"
C	7 mm	9/32"
D	20 mm	3/4"
E	23 mm	29/32"
G	28 mm	1-1/8"
H	17 mm	43/64"
I	13 mm	1/2"
K	37 mm	1-7/16"
L	11 mm	7/16"
M	M6 mm	M6
N	9 mm	11/32"