

## Eye nut RM - 1/2"-13UNC

Artikel-Nr: 7101104



For the RUD RM - eye nuts, the threaded connector component must be of at least quality grade 8.8

- Considerably higher WLL (in comparison to DIN 582) at vertical load.
- Large thread and WLL range (M6-M48, 0.1 t – 8 t).
- Clear marking of the minimum WLL for all loading directions.
- Quick and easy installation with just one bolt connection.

Other important RUD specific information and specialities to our RUD lifting points can be found in the specific user instruction.

## Eye nut RM - 1/2"-13UNC

Artikel-Nr: 7101104

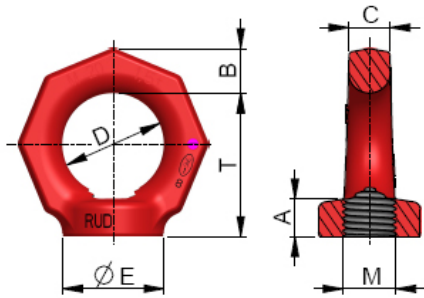

<b>weight</b>	0.17 kg	0.37 lbs
<b>Nominal WLL</b>	350 kg	770 lbs
<b>T</b>	41 mm	1-5/8"
<b>A</b>	14 mm	9/16"
<b>B</b>	13 mm	1/2"
<b>C</b>	12 mm	15/32"
<b>D</b>	30 mm	1-3/16"
<b>E</b>	30 mm	1-3/16"
<b>M</b>	1/2"-13UNC mm	1/2"-13UNC