

## Eye nut RM - 3/4"-10UNC

Artikel-Nr: 7101106



For the RUD RM - eye nuts, the threaded connector component must be of at least quality grade 8.8

- Considerably higher WLL (in comparison to DIN 582) at vertical load.
- Large thread and WLL range (M6-M48, 0.1 t – 8 t).
- Clear marking of the minimum WLL for all loading directions.
- Quick and easy installation with just one bolt connection.

Other important RUD specific information and specialities to our RUD lifting points can be found in the specific user instruction.

## Eye nut RM - 3/4"-10UNC

Artikel-Nr: 7101106

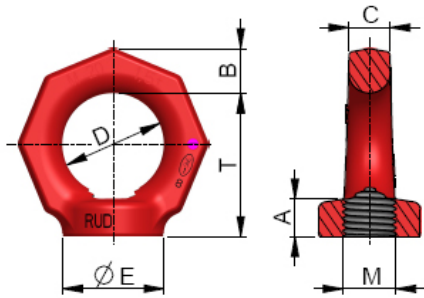

<b>weight</b>	0.39 kg	0.86 lbs
<b>Nominal WLL</b>	1200 kg	2640 lbs
<b>T</b>	55 mm	2-5/32"
<b>A</b>	18 mm	23/32"
<b>B</b>	17 mm	43/64"
<b>C</b>	16 mm	5/8"
<b>D</b>	40 mm	1-9/16"
<b>E</b>	40 mm	1-9/16"
<b>M</b>	3/4"-10UNC mm	3/4"-10UNC