

Eye nut RM - 7/8"-9BSW

Artikel-Nr: 7993988



For the RUD RM - eye nuts, the threaded connector component must be of at least quality grade 8.8

- Considerably higher WLL (in comparison to DIN 582) at vertical load.
- Large thread and WLL range (M6-M48, 0.1 t – 8 t).
- Clear marking of the minimum WLL for all loading directions.
- Quick and easy installation with just one bolt connection.

Other important RUD specific information and specialities to our RUD lifting points can be found in the specific user instruction.

Eye nut RM - 7/8"-9BSW

Artikel-Nr: 7993988

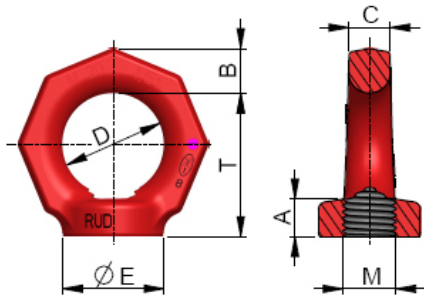

weight	0.70 kg	1.54 lbs
Nominal WLL	1500 kg	3300 lbs
T	70 mm	2-3/4"
A	22 mm	7/8"
B	21 mm	13/16"
C	20 mm	3/4"
D	50 mm	1-31/32"
E	50 mm	1-31/32"
M	7/8" mm	7/8"