

## Nut DIN 980-V M8 crack detected

Artikel-Nr: 7990532



100% crack detected, prevailing torque hexagon nut type according to DIN 980 - V (all-metal design) with a zinc - plated surface. With a plain washer (extra item) suitable for the assembly of lifting points with long threaded bolts for example in through holes.

## Nut DIN 980-V M8 crack detected

Artikel-Nr: 7990532

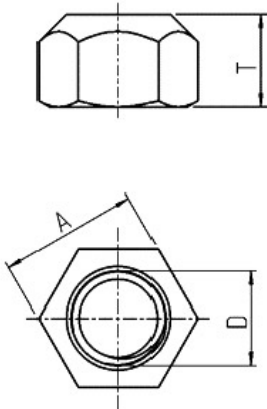

<b>weight</b>	0.01 kg	0.02 lbs
<b>T</b>	8 mm	5/16"
<b>A</b>	13 mm	1/2"
<b>D</b>	M8 mm	M8