

Nut DIN 980-V M10 crack detected

Artikel-Nr: 7990533

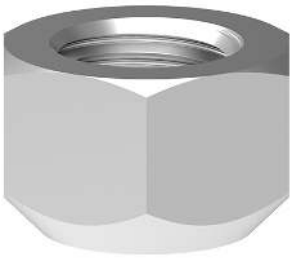

100% crack detected, prevailing torque hexagon nut type according to DIN 980 - V (all-metal design) with a zinc - plated surface. With a plain washer (extra item) suitable for the assembly of lifting points with long threaded bolts for example in through holes.

Nut DIN 980-V M10 crack detected

Artikel-Nr: 7990533

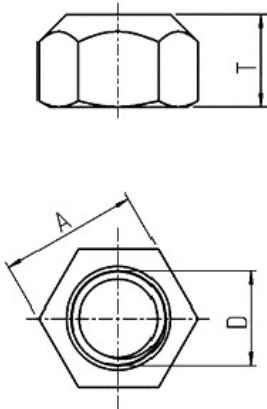

weight	0.01 kg	0.02 lbs
T	10 mm	25/64"
A	17 mm	43/64"
D	M10 mm	M10