

Nut DIN 980-V M20 crack detected

Artikel-Nr: 7990536



100% crack detected, prevailing torque hexagon nut type according to DIN 980 - V (all-metal design) with a zinc - plated surface. With a plain washer (extra item) suitable for the assembly of lifting points with long threaded bolts for example in through holes.

Nut DIN 980-V M20 crack detected

Artikel-Nr: 7990536

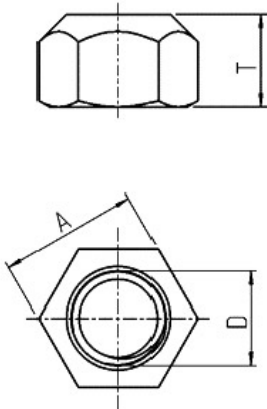

weight	0.07 kg	0.14 lbs
T	20 mm	25/32"
A	30 mm	1-3/16"
D	M20 mm	M20