

Nut DIN 980-V M24 crack detected

Artikel-Nr: 7990537



100% crack detected, prevailing torque hexagon nut type according to DIN 980 - V (all-metal design) with a zinc - plated surface. With a plain washer (extra item) suitable for the assembly of lifting points with long threaded bolts for example in through holes.

Nut DIN 980-V M24 crack detected

Artikel-Nr: 7990537

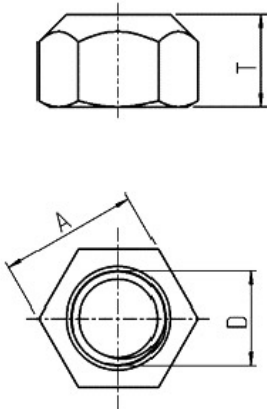

weight	0.12 kg	0.26 lbs
T	24 mm	15/16"
A	36 mm	1-27/64"
D	M24 mm	M24