

Nut DIN 980-V M48 crack detected

Artikel-Nr: 7990541



100% crack detected, prevailing torque hexagon nut type according to DIN 980 - V (all-metal design) with a zinc - plated surface. With a plain washer (extra item) suitable for the assembly of lifting points with long threaded bolts for example in through holes.

Nut DIN 980-V M48 crack detected

Artikel-Nr: 7990541

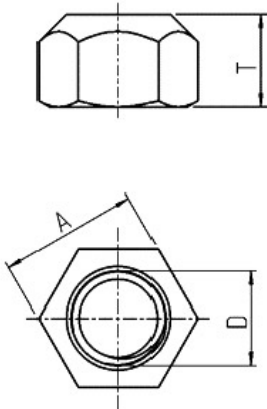

weight	0.84 kg	2.1 lbs
T	48 mm	1-7/8"
A	75 mm	2-61/64"
D	M48 mm	M48