

Nut DIN 980-V M56 crack detected

Artikel-Nr: 7995776



100% crack detected, prevailing torque hexagon nut type according to DIN 980 - V (all-metal design) with a zinc - plated surface. With a plain washer (extra item) suitable for the assembly of lifting points with long threaded bolts for example in through holes.

Nut DIN 980-V M56 crack detected

Artikel-Nr: 7995776

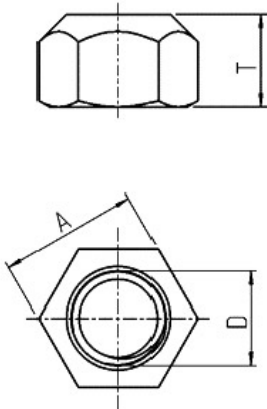

weight	1.00 kg	2.20 lbs
T	56 mm	2-3/16"
A	85 mm	3-11/32"
D	56 mm	2-3/16"