

PowerPoint PP-VIP10-3,5t-M27

Artikel-Nr:

8600323



- **Universal and non-mix-up clevis connection for chains, hooks and eye.**
- **Double ball bearing** is the optimal solution for turning and flipping operations under full load (not suitable for permanent turning under load).
- **Lifting points pivots 360°.**
- **Large distance between bolt-on surface and load to avoid damage.**
- **Rotatable at nominal WLL, 90° to the bolt-on direction** Lowest kinking possibility due to cardan joint.
- Clear marking of the minimum WLL for all loading directions.
- Marking with requested torque moment and nominal WLL with a safety factor of 4:1 (MRL 2006/42/EG) and 5:1 (ASME B 30.26).
- Tested and certified by DGUV, Testing specifications: GS-OA-15-04:2012-05, Certificate-No.: OA 1451017
- Significant product characteristics of the PP-S, PP-B and PP-VIP are subject to property right claims.
- Quick and easy installation with just one bolt connection.
- Hand tightening with appropriate wrench is sufficient for a singular lift.
- Please observe torque instructions when lifting point is permanently installed resp. at constant swivelling operations and tilting/ turning actions.

Other important RUD specific information and specialities to our RUD lifting points can be found in the specific user instruction.

PowerPoint PP-VIP10-3,5t-M27

Artikel-Nr: 8600323

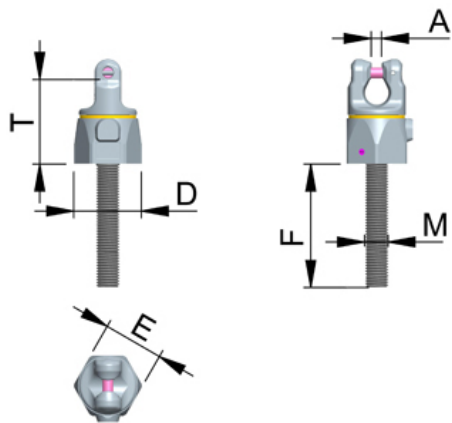

weight	2.47 kg	5.45 lbs
Nominal WLL	3500 kg	7700 lbs
T	94 mm	3-11/16"
A	10 mm	3/8"
D	81 mm	3-3/16"
E	70 mm	2-3/4"
F	41 mm	1-5/8"
M	M27 mm	M27