

## So-PowerPoint PP-VIP6-1t-M14 with max-length F=65

Artikel-Nr:

8600326



Thread reach from F = 65 mm is available. When ordering implicitly indicate the required length. WLL is equivalent to that of WBG-V, since a corresponding lower part is used. Connection only with RUD approved components e.g; VCÖH-6, oval link, PP 1tkg or the 6 mm VIP chain. Hint : The VIP chain connection is fool proof. When assembling the components, pay attention to the correct WLL allocation.

- Can be combined with most commercial lifting means without additional connecting element.
- Lifting points pivots 360°.
- Large distance between bolt-on surface and load to avoid damage.
- Rotatable at nominal WLL, 90° to the bolt-on direction. Lowest kinking possibility due to cardan joint.
- Clear marking of the minimum WLL for all loading directions.
- Marking with requested torque moment and nominal WLL with a safety factor of 4:1(MRL 2006/42/EG) and 5:1 (ASME B 30.26).
- Component according to the test criterias of BG/DGUV "GS-OA-15-04".
- Significant product characteristics of the PP-S, PP-B and PP-VIP are subject to property right claims.
- The shape of the hook tip avoids unintentional attachment into small holes and tip loading. Robust, forged safety latch.
- Quick and easy installation with just one bolt connection.
- Hand tightening with appropriate wrench is sufficient for a singular lift.
- Please observe torque instructions when lifting point is permanently installed resp. at constant swivelling operations and tilting/ turning actions.

Other important RUD specific information and specialities to our RUD lifting points can be found in the specific user instruction.

So-PowerPoint PP-VIP6-1t-M14 with max-length F=65

Artikel-Nr: 8600326

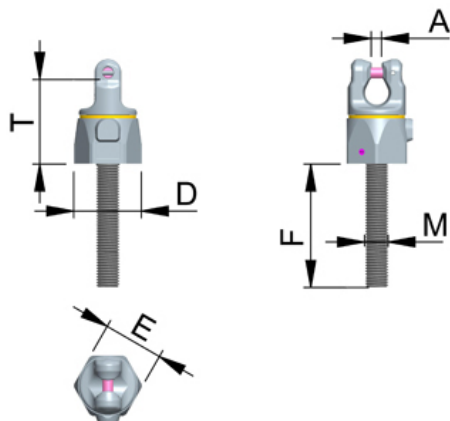

weight	0.91 kg	2.01 lbs
Nominal WLL	1000 kg	2200 lbs
T	58 mm	2-9/32"
A	6 mm	15/64"
D	48 mm	1-7/8"
E	41 mm	1-5/8"
F	65 mm	2-9/16"
M	M14 mm	M14