

So-PowerPoint PP-VIP8-2t-M20X1,5 with variable length

Artikel-Nr:

8600322



Thread reach from $F = 20-89 \text{ mm}$ is available. (with through thread)

When ordering implicitly indicate the required length.

Connection only with RUD approved components e.g; VCÖH-8, oval link, PP 2t kg or the 8 mm VIP chain.

Hint : The VIP chain connection is fool proof. When assembling the components, pay attention to the correct WLL allocation.

- **Can be combined with most commercial lifting means without additional connecting element.**
- **Lifting points pivots 360° .**
- **Large distance between bolt-on surface and load to avoid damage.**
- **Rotatable at nominal WLL, 90° to the bolt-on direction**Lowest kinking possibility due to cardan joint.
- **Suspension ring with enlarged pivoting area.**
- Clear marking of the minimum WLL for all loading directions.
- Variable thread lengths are available for use of threaded holes and through hole fixtures.
- Non removable special bolt (this reduces the risk of non standard bolts).
- Component according to the test criterias of BG/DGUV "GS-OA-15-04".
- Quick and easy installation with just one bolt connection.
- Hand tightening with appropriate wrench is sufficient for a singular lift.
- Please observe torque instructions when lifting point is permanently installed resp. at constant swivelling operations and tilting/ turning actions.

Other important RUD specific information and specialities to our RUD lifting points can be found in the specific user instruction.

So-PowerPoint PP-VIP8-2t-M20X1,5 with variable length

Artikel-Nr: 8600322

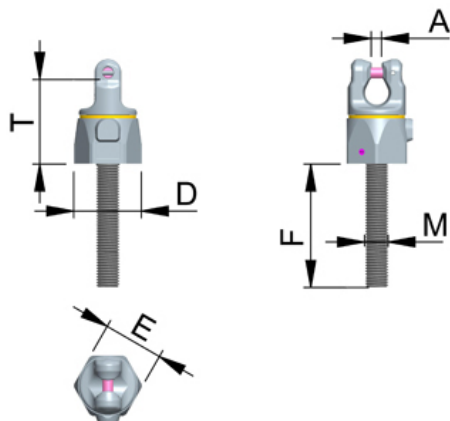

Nominal WLL	2000 kg	4400 lbs
T	61 mm	2-13/32"
A	8 mm	5/16"
D	61 mm	2-13/32"
E	55 mm	2-5/32"
F	20-89 mm	13/16" up to 3-1/2"
M	M20X1,5 mm	M20X1,5