

PowerPoint PP-VIP4-0,6t-1/2"-13UNC with variable length

Artikel-Nr:

8600320



Suitable for all loads which swivel and tilt. From the factory, bolt lengths from F=40-149 can be supplied (with an approximately 21 mm shank without thread). When ordering implicitly indicate the required length. WLL is equivalent to that of VWBG-V, since a corresponding lower part is used. Connection only with RUD approved components e.g; VCÖH-4, oval link, PP 0,6tkg or the 4 mm VIP chain. Hint : The VIP chain connection is fool proof. When assembling the components, pay attention to the correct WLL allocation.

- **Can be combined with most commercial lifting means without additional connecting element.**
- **Lifting points pivots 360°.**
- **Large distance between bolt-on surface and load to avoid damage.**
- **Rotatable at nominal WLL, 90° to the bolt-on direction**Lowest kinking possibility due to cardan joint.
- **Suspension ring with enlarged pivoting area.**
- Clear marking of the minimum WLL for all loading directions.
- Variable thread lengths are available for use of threaded holes and through hole fixtures.
- Non removable special bolt (this reduces the risk of non standard bolts).
- Component according to the test criterias of BG/DGUV "GS-OA-15-04".
- Quick and easy installation with just one bolt connection.
- Hand tightening with appropriate wrench is sufficient for a singular lift.
- Please observe torque instructions when lifting point is permanently installed resp. at constant swivelling operations and tilting/ turning actions.

Other important RUD specific information and specialities to our RUD lifting points can be found in the specific user instruction.

PowerPoint PP-VIP4-0,6t-1/2"-13UNC with variable length

Artikel-Nr: 8600320

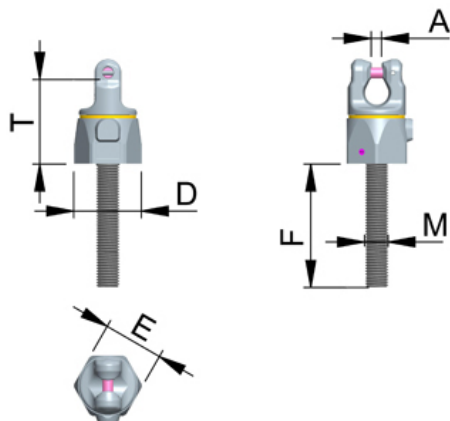

Nominal WLL	600 kg	1320 lbs
T	47 mm	1-7/8"
A	4 mm	5/32"
D	42 mm	1-21/32"
E	36 mm	1-27/64"
F	40-149 mm	1-9/16" up to 5-7/8"
M	1/2"-13UNC mm	1/2"-13UNC