

So-PowerPoint PP-VIP6-1,3t-5/8"-11UNC with variable length

Artikel-Nr: 8600321



Suitable for all loads which swivel and tilt. From the factory, bolt lengths from F=50-180 can be supplied (with an approximately 28 mm shank without thread). When ordering implicitly indicate the required length. WLL is equivalent to that of VWBG-V, since a corresponding lower part is used. Connection only with RUD approved components e.g; VCÖH-6, oval link, PP 1,3tkg or the 6 mm VIP chain. Hint : The VIP chain connection is fool proof. When assembling the components, pay attention to the correct WLL allocation.

- **Can be combined with most commercial lifting means without additional connecting element.**
- **Lifting points pivots 360°.**
- **Large distance between bolt-on surface and load to avoid damage.**
- **Rotatable at nominal WLL, 90° to the bolt-on direction**Lowest kinking possibility due to cardan joint.
- **Suspension ring with enlarged pivoting area.**
- Clear marking of the minimum WLL for all loading directions.
- Variable thread lengths are available for use of threaded holes and through hole fixtures.
- Non removable special bolt (this reduces the risk of non standard bolts).
- Component according to the test criterias of BG/DGUV "GS-OA-15-04".
- Quick and easy installation with just one bolt connection.
- Hand tightening with appropriate wrench is sufficient for a singular lift.
- Please observe torque instructions when lifting point is permanently installed resp. at constant swivelling operations and tilting/ turning actions.

Other important RUD specific information and specialities to our RUD lifting points can be found in the specific user instruction.

So-PowerPoint PP-VIP6-1,3t-5/8"-11UNC with variable length

Artikel-Nr: 8600321

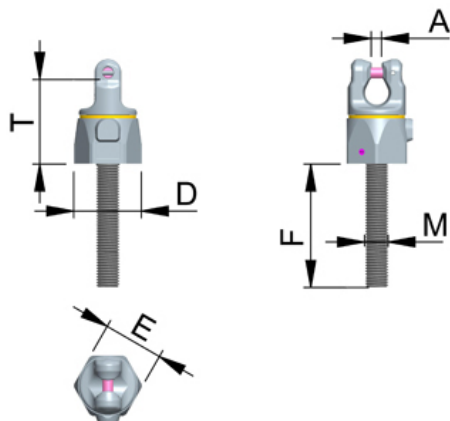

Nominal WLL	1300 kg	2860 lbs
T	58 mm	2-9/32"
A	6 mm	15/64"
D	48 mm	1-7/8"
E	41 mm	1-5/8"
F	50-180 mm	1-31/32" up to 7-
M	5/8"-11UNC mm	5/8"-11UNC