

## Load ring VLBG-PLUS 3,5t M20 with bolt

Artikel-Nr: 8504657



- **Lifting points pivots 360°. Suspension ring pivots 180°**
- **optimal WLL with captive but exchangeable ICE-Bolt** made out of patented steel with special corrosion protection Corrud-DT. Non-hazardous deep temperature usage down to -60°; higher toughness and therefore higher bending strength as well as less wear occurrence. Original ICE-Bolt is available as a spare part. Clear marking at the bolt head: RUD, ICE, thread size, batchno., class of strength.
- **Clamping spring** works as a noise reduction and holds the suspension ring in the requested position; therefore simple hinge of lifting mean possible respectively flat design if turned down.
- **Clear marking of the minimum WLL for all loading directions**
- Available as:
  - Standard Metric Thread (DIN EN 13)
- Variable bolt lengths available for tapped or through holes.
- Tested and certified by DGUV Testing specifications: GS-OA-15-04:2015-12  
Certificate No.: OA 1651053
- Quick and easy installation with just one bolt connection.
- Assembly with flat / ring wrench or allen key possible.
- Hand tightening with appropriate wrench is sufficient for a singular lift.
- Please observe torque instructions when lifting point is permanently installed resp. at constant swivelling operations and tilting/ turning actions.

Other important RUD specific information and specialities to our RUD lifting points can be found in the specific user instruction.

## Load ring VLBG-PLUS 3,5t M20 with bolt

Artikel-Nr: 8504657

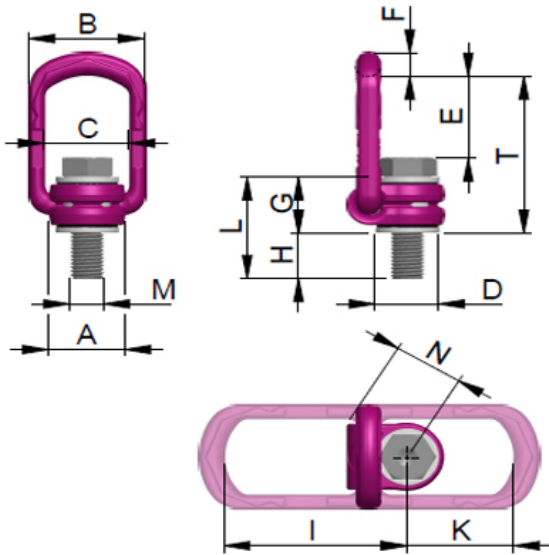

<b>weight</b>	1.30 kg	2.87 lbs
<b>Nominal WLL</b>	3500 kg	7700 lbs
<b>T</b>	110 mm	4-11/32"
<b>A</b>	50 mm	1-31/32"
<b>B</b>	82 mm	3-1/4"
<b>C</b>	54 mm	2-1/8"
<b>D</b>	45 mm	1-25/32"
<b>E</b>	55 mm	2-5/32"
<b>F</b>	16,5 mm	21/32"
<b>G</b>	43 mm	1-11/16"
<b>H</b>	32 mm	1-1/4"
<b>I</b>	113 mm	4-7/16"
<b>K</b>	64 mm	2-1/2"
<b>L</b>	75 mm	2-15/16"
<b>M</b>	M20 mm	M20
<b>N</b>	48 mm	1-7/8"