

Securing set for ISH-4, VMH-4 and VCÖH 4

Artikel-Nr: 7987901



Consisting of a robust safety latch, a triple coiled double leg corrosion protected spring and a retaining pin. Only complete sets can be supplied. Easy clinch sealing using a hammer.

Securing set for ISH-4, VMH-4 and VCÖH 4

Artikel-Nr: 7987901

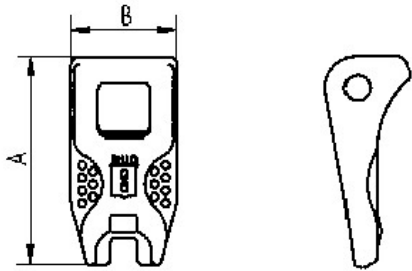

weight	0.02 kg	0.04 lbs
A	36 mm	1-27/64"
B	17 mm	43/64"

