

Securing set for ISH 8

Artikel-Nr: 7100301



Consisting of a forged safety latch, a triple coiled corrosion protected double leg spring and a tensioning sleeve. Only whole sets can be supplied. Can easily be assembled and disassembled using a hammer and a drift punch.

Securing set for ISH 8

Artikel-Nr: 7100301

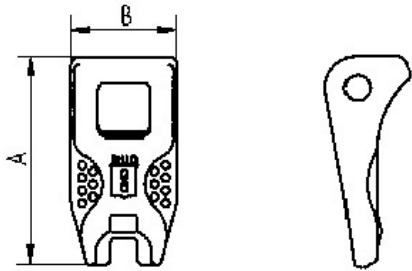

weight	0.12 kg	0.26 lbs
A	66 mm	2-5/8"
B	33 mm	1-5/16"

