

Securing set for ISH 13

Artikel-Nr: 7100303



Consisting of a forged safety latch, a triple coiled corrosion protected double leg spring and a tensioning sleeve. Only whole sets can be supplied. Can easily be assembled and disassembled using a hammer and a drift punch.

Securing set for ISH 13

Artikel-Nr: 7100303

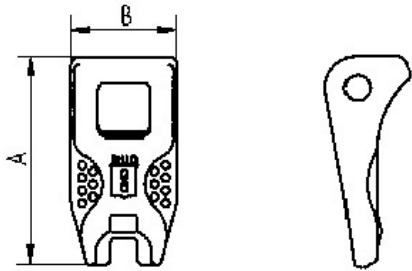

weight	0.33 kg	0.73 lbs
A	92 mm	3-5/8"
B	50 mm	1-31/32"

