

## Securing set for ISH 16

Artikel-Nr: 7900419



Consisting of a forged safety latch, a triple coiled corrosion protected double leg spring and a tensioning sleeve. Only whole sets can be supplied. Can easily be assembled and disassembled using a hammer and a drift punch.

## Securing set for ISH 16

Artikel-Nr: 7900419

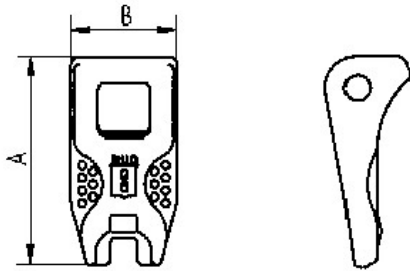

weight	0.38 kg	0.84 lbs
A	100 mm	3-15/16"
B	51 mm	2"

