

VIP-Universal Swivel UW-PP 10

Artikel-Nr: 7990881



- With a ball bearing which enables swiveling under load.
- Patented clevis system facilitating a universal connection
- Can be loaded in all directions with the shortest combination possibilities.

Assemble only with approved RUD - VIP - chain and ring components:

- VIP-Cobra eye hook VCÖH
- Oval-Link PP-B for PowerPoint

Attention: The VIP-Chain connection is fool-proof. When assembling, especially with the ring components, pay attention to the correct WLL! Not suitable for permanent use and swiveling under full load. Connecting bolt and tensioning sleeve are pre-assembled. The BGR 500/DGUV-Regel 100-500 stipulates that slings never be used while in a twisted condition. This requirement is automatically met by the UW-PP because of the integrated ball bearing.

VIP-Universal Swivel UW-PP 10

Artikel-Nr: 7990881

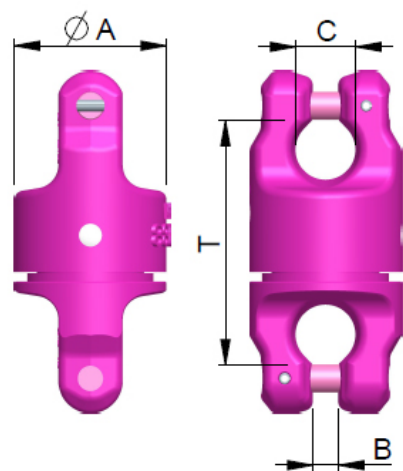

weight	1.91 kg	4.21 lbs
Nominal WLL	4000 kg	8800 lbs
T	106 mm	4-3/16"
A	66 mm	2-5/8"
B	11 mm	7/16"
C	26 mm	1"