

So-PowerPoint PP-VIP16-8t-M42 with variable length

Artikel-Nr: 8600305



Thread reach from F = 42-300 mm is available. Including washer and a crack detected nut. When ordering implicitly indicate the required length. Connection only with RUD approved components e.g; VCÖH-16, oval link, PP 8tkg or the 16 mm VIP chain. Hint : The VIP chain connection is fool proof. When assembling the components, pay attention to the correct WLL allocation.

- Can be combined with most commercial lifting means without additional connecting element.
- Lifting points pivots 360°.
- Large distance between bolt-on surface and load to avoid damage.
- Rotatable at nominal WLL, 90° to the bolt-on direction. Lowest kinking possibility due to cardan joint.
- Clear marking of the minimum WLL for all loading directions.
- Marking with requested torque moment and nominal WLL with a safety factor of 4:1(MRL 2006/42/EG) and 5:1 (ASME B 30.26).
- Component according to the test criterias of BG/DGUV "GS-OA-15-04".
- Significant product characteristics of the PP-S, PP-B and PP-VIP are subject to property right claims.
- The shape of the hook tip avoids unintentional attachment into small holes and tip loading. Robust, forged safety latch.
- Quick and easy installation with just one bolt connection.
- Hand tightening with appropriate wrench is sufficient for a singular lift.
- Please observe torque instructions when lifting point is permanently installed resp. at constant swivelling operations and tilting/ turning actions.

Other important RUD specific information and specialities to our RUD lifting points can be found in the specific user instruction.

So-PowerPoint PP-VIP16-8t-M42 with variable length

Artikel-Nr: 8600305

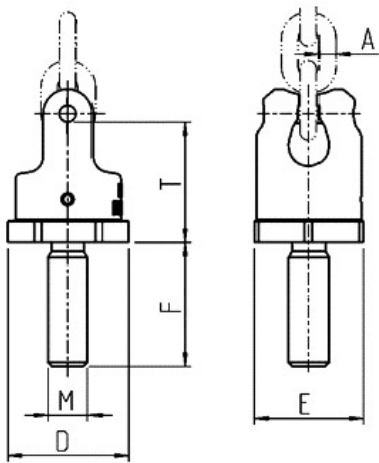

Nominal WLL	8000 kg	17600 lbs
T	100 mm	3-15/16"
A	16 mm	5/8"
D	100 mm	3-15/16"
E	90 mm	3-17/32"
F	42-300 mm	1-5/8" up to 11-
M	M42 mm	M42